

DOOR MANAGEMENT SYSTEMS

with technology

flexicon

MULTIFUNCTIONAL
INPUTS/OUTPUTS

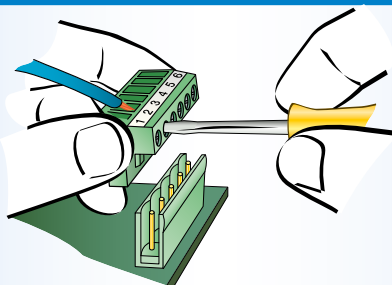

"FLEXICON" WIRING

Conventional cables systems with screw-type terminal board for medium and large section cables **for medium and long range connections.**

STAND-ALONE UNIT

**Readers and numerical keypads
for creating access control systems**



3 devices with **5** different functions,
in a single unified convertible module

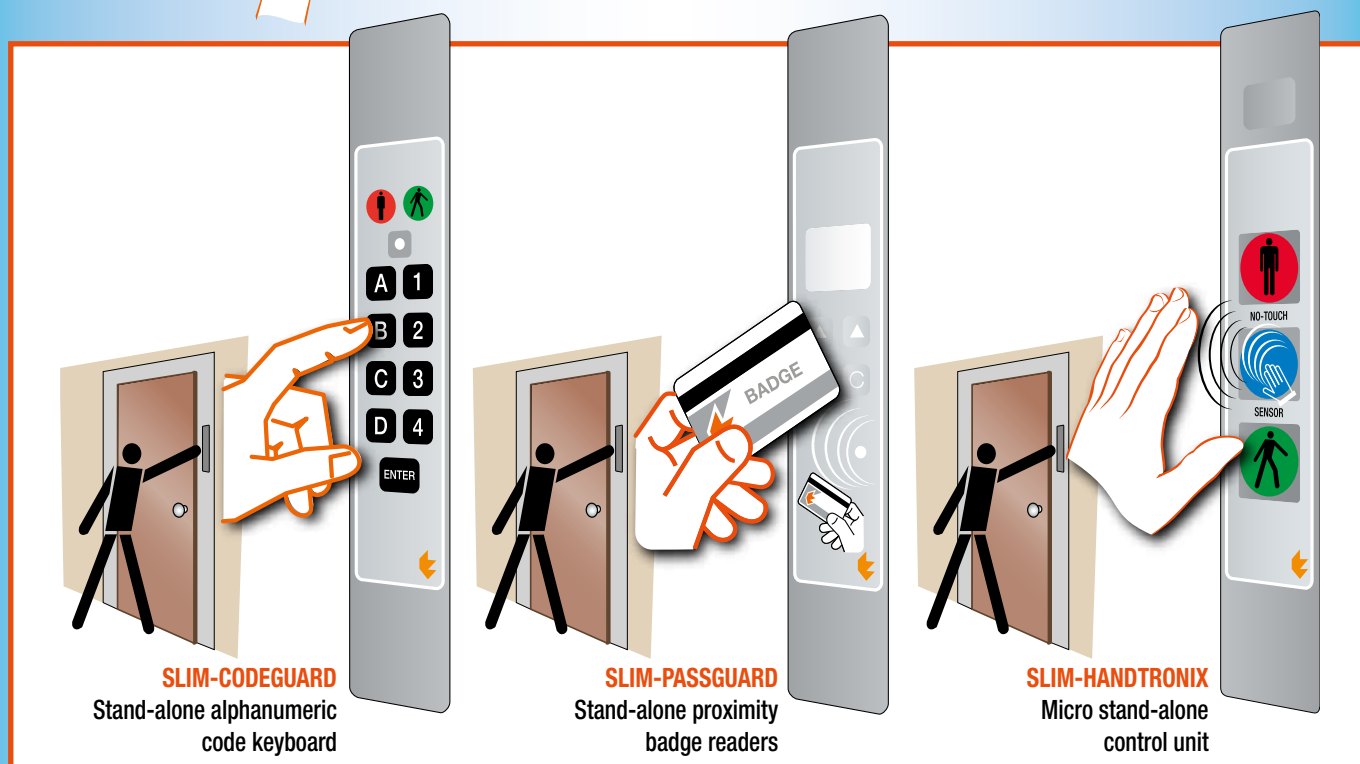

in 5 installation types next to door.



Ultraslim and supercompact devices in unified convertible format in 5 installation types next to door.

Alphanumeric
keypads
SLIM-CODEGUARD

Proximity
badge readers
SLIM-PASSGUARD

Micro stand-alone
control unit
SLIM-HANDTRONIX

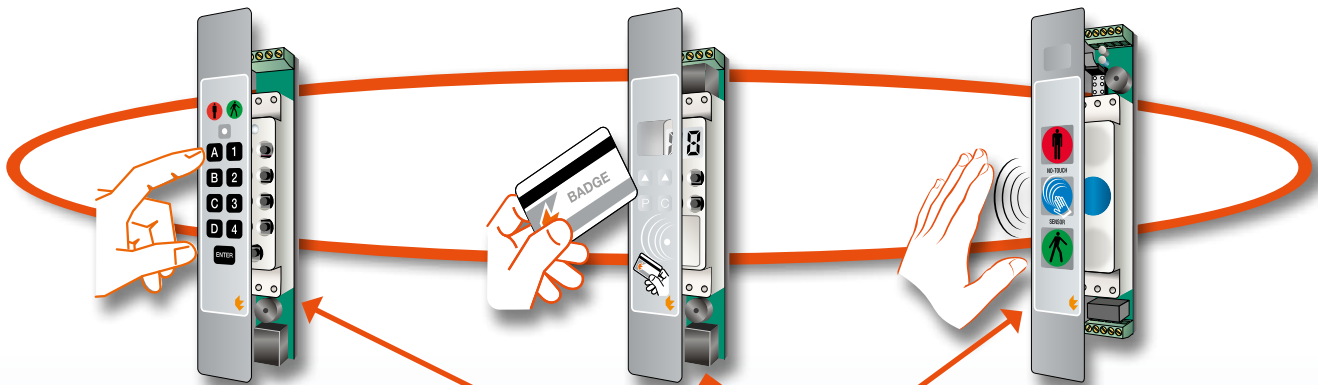

Unified module because....

A full SLIM & MODULAR range of devices with different functions, operations and purposes (code key pad, badge readers, micro stop and go display control panels, and stop and go display panels, entryphones and button panels on same series...) designed and made bearing in mind a single module of one size (Same for all). In fact, all the devices have the same appearance, size and modularity in order to be interchangeable and to be housed in the same unified chasing of the previous lock.

Convertible because...

Using unified flanges, cases and boxes, any unified SLIM & MODULAR device is convertible into 5 different types that can be installed in any way, next to the door, based on the assembly needs found in the field.

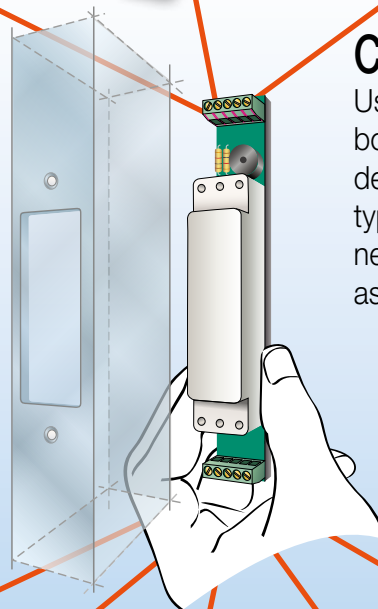

Assembly type 1
fully aligned concealed
for recess-mounting without flange on the same plane of the door frame panel

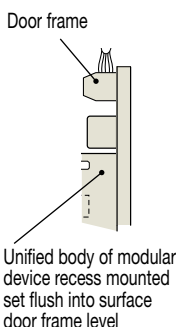

Assembly type 2
fully aligned at milling
or recess-mounting with front flange on the same plane of the panel surface

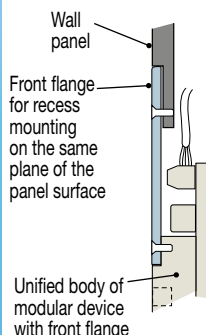

Assembly type 3
for conventional flush mounting
with front flange overlapping door frame

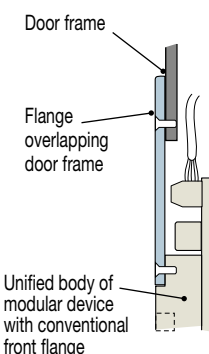

Assembly type 4
for surface mounting
with using housing

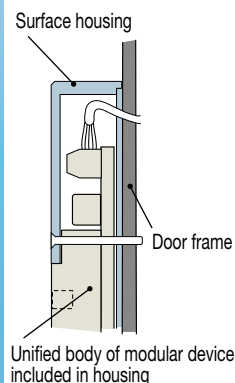

Assembly type 5
for recessed wall-mounting
with flange and wall-mounting receptacle

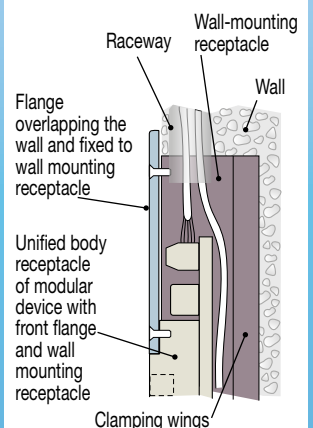

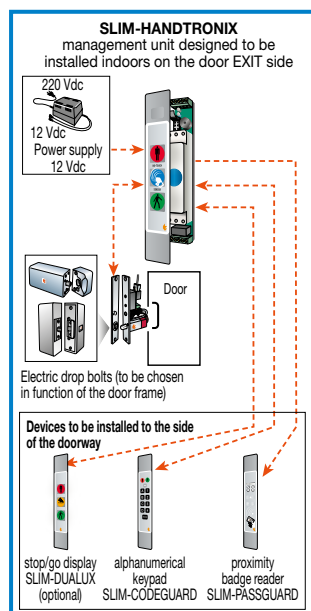

SLIM-HANDTRONIX (no touch)

PROFESSIONAL TECNODIMENSIONE MICRO STAND-ALONE CONTROL UNIT FOR THE MANAGEMENT OF SINGLE DOORS

This unit is not simply "No-touch sensorized Stop/Go display" but actually micro stand-alone unit designed to fully control one single door equipped with electrical lock.

One unit for... **5** different needs...

- 1st** Timed unlocking command with automatic re-locking
- 2nd** Electric drop bolt/door strike program
- 3rd** Tamper protection
- 4th** Optical and/or acoustic signals
- 5th** Output for remote signals

ENTRANCE TO RESTRICTED AREA IS ALWAYS PROTECTED AND CONTROLLED.

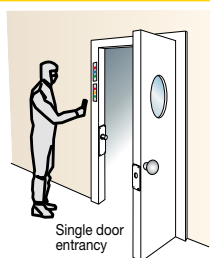
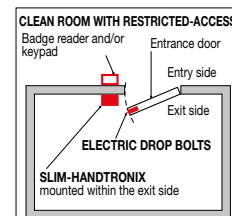

GENERAL CONSIDERATIONS

In Clean room plants, it happens that the entrance to some rooms is not subjected by crossing tunnel (filter) arranged with interlocked doors; in other words it is possible to enter the area through one single door only.

However, usually the door is supervised by proper keypad device and/or badge reader to permit the access to the persons only that are specifically authorised and process then own badge or by entering the valid code.

It is a matter of fact that currently, even advanced, keypads and badge readers etc. are designed to provide a temporized command to electrical locks, but are not equipped with logic to control the bolt movement (the automatic returning projection of the bolt in locking position).

Now thanks to the Tecnodimensione SLIM-HANDTRONIX unit, every access-control devices is in condition to manage any type of solenoid bolt, electromagnet, electrical door strike... it is not necessary to use control unit with substantial cost saving.

1st

TIMED UNLOCKING COMMAND WITH AUTOMATIC RE-LOCKING (time required to authorise the door opening)

Temporization: timed unlocking command - settable as desired (1-8-20-60 sec.). When the electric "open door" command is given, from badge reader for example, a delay program allows the door lock to remain open for a preset interval (3 to 8 sec.), the time needed to push the door open and enter. When the interval ends the door lock re-locks itself automatically, even if the door isn't open, thus preventing unauthorised intrusions.

temporary unlocking: (open unlatched)

In case of maintenance, cleaning, moving, etc., the door can be set "open unlatched", only by a proper command, which allows an unlimited number of door openings without the electrical lock be operated after each passage.

2nd

ELECTRIC DROP BOLT/DOOR STRIKE PROGRAM

Electric drop bolt (bolt movement control)

When authorized command is launched, and the door is pushed and opened for a transit, the bolt of the lock stands "retracted" and it will return "projected" in locking position, just only when the door-leaf will be pull over to the doorpost again.

In this way, a classic door closer (pump) can completely set the door ajar without facing any mechanical resistance and friction.

Electric door strike

When commanded to open, the counter spring wing of the door strike is released for the programmed time, but re-locks as soon the leaf of the door is opened to prevent rebounding while the door is reapproaching to shut up.

3rd

TAMPER PROTECTION

When in stand-by the door is locked, the unit supervises the door-proximity sensor against the tamper aiming to switch its own contacts.

In other words, in stand-by condition, the locking of the bolt is not affected by interruption or alteration of the magnetic field of the reed sensor.

4th

OPTICAL AND/OR ACOUSTIC ALARMS

These signals report if there is a problem with the door. The built-in buzzer activates and the lights of the Stop/Go display flash to signal the following conditions:

- If the door after an authorized transit stays open over a preset time (time-out adjustable 30 sec).
- Every opening obtained unlikely through breaking effraction gives an automatic immediate alarm output. Really the opening of the door is permitted electrically using only authorized command arrived by badge reader for example.

5th

OUTPUT FOR REMOTE SIGNALS

Corresponding to "door proximity status" + "bolt status" (bolt projected or retracted) to confirm remotely that the door is closed & locked.

In addition it is provided with connection to arrange door opening by remote push buttons.

What's more it's also MODULAR

Is the exact same shape and size as all other devices of "Clean room" line, and therefore is interchangeable and can be recess mounted as desired in the same cutting and doorframe fittings.

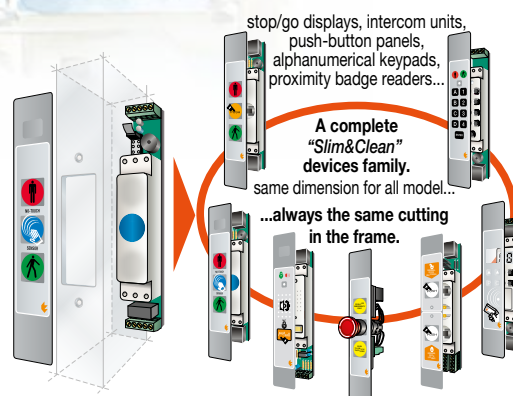

SLIM-HANDTRONIX (no touch)

STAND ALONE UNIT FOR THE MANAGEMENT OF SINGLE DOORS



This unit is not simply "No-touch sensorized Stop/Go display" but actually micro stand-alone unit designed to fully control one single door equipped with electrical lock.

This unit provides the following innovative features:

- **Temporizzazione:** timed unlocking command - settable as desired (1-8-20-60 sec.) When the interval ends the door lock re-locks itself automatically, even if the door isn't open, thus preventing unauthorised intrusions.
- **Temporary unlimited unlocking** (door locked in open position): this feature enables to permanently unlock the door for cleaning and other purposes.
- **Temporary unlocking:** (open unlatched) - In case of maintenance, cleaning, moving, etc., the door can be set "open unlatched", only by using the key command, which allows an unlimited number of door openings without the electrical lock be operated after each passage.

Electric striker: the wing returns to lock position as soon as the door is opened to avoid debounce when being closed.

- **Tamper protection:** When in stand-by the door is locked, the unit supervises the door-proximity sensor against the tamper aiming to switch its own contacts. In other words, in stand-by condition, the locking of the bolt is not affected by interruption or alteration of the magnetic field of the reed sensor.
- **Optical and/or acoustic alarms:** These signals report if there is a problem with the door. The built-in buzzer activates and the lights of the Stop/Go display flash to signal the following conditions:
 - If the door after an authorized transit stays open over a preset time (time-out adjustable 30 sec).
 - Every opening obtained unlikely through breaking effraction gives an automatic immediate alarm output. Really the opening of the door is permitted electrically using only authorized command arrived by badge readir for example. - 12 Vdc/120 mA power supply.

Export Product-list
January 2024



TECNODIMENSIONE®

Ordering
information



PRICE
in Euro

Q.ty

Models for 12 Vdc power supply

MODELS

€ each

N°

Assembly type 1

fully aligned concealed for recess-mounting without flange on the same plane of the door frame panel *

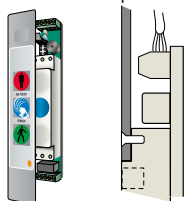

SLIM-HANDTRONIX stand alone unit type 1 with fully aligned concealed for recess-mounting on the same plane of the door frame panel without flange. Ideal to achieve a "smooth" surface (without roughness) that is easy to clean. Supplied with diffuser screen and gap G for sections with a thickness of 1.6mm. Fitted (instead of the manual push button) with an infrared sensor that "sees" a presence up to 10cm away. Basically, the "contactless" door opening and/or doorbell command is automatically triggered by bringing the hand close to the unit, without actually touching it. Complete with self-adhesive cover designed to be applied after the final installation of the system.

* In this case it is advisable to prepare the recess during the door frame machining.

Same with front panel and gap G for sections with a thickness of 3mm.

034991HM

228,00

034991HM3

228,00

Assembly type 2

fully aligned at milling for recess-mounting with front flange on the same plane of the panel surface ♦

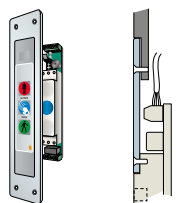

SLIM-HANDTRONIX stand alone unit type 2 for aligned recessed flush fitting in bottom of panel using front flange (e.g. To mount on wall panel next to the door frame on the post where no chasing can be carried out).

Fitted (instead of the manual push button) with an infrared sensor that "sees" a presence up to 10cm away. Basically, the "contactless" door opening and/or doorbell command is automatically triggered by bringing the hand close to the unit, without actually touching it. Supplied with front flange in anodized aluminium with "silver" finish - 250x50mm, thickness 2.5mm for recess-mounting on the same plane of the panel surface for aligned recessed flush fitting in bottom of plane using front flange.

Cover pre-assembled and fixed into the flange niche.

♦ In this case, it is advisable to prepare sunk milling during the panel machining phase.

034992HM

255,00

Assembly type 3

for conventional flush mounting with front flange overlapping door frame

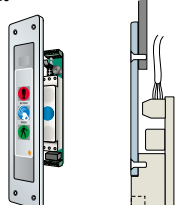

SLIM-HANDTRONIX stand alone unit, type 3 for traditional recessed fitting using flange. Supplied with front flange in anodized aluminium with "silver" finish - 250x50mm, thickness 4mm for flush mounting.

Fitted (instead of the manual push button) with an infrared sensor that "sees" a presence up to 10cm away.

Basically, the "contactless" door opening and/or doorbell command is automatically triggered by bringing the hand close to the unit, without actually touching it.

Cover pre-assembled and fixed into the flange niche.

Mounting can be carried out "on site", directly onto the installed door frame.

034993HM

266,00

Assembly type 4

for surface mounting with using housing

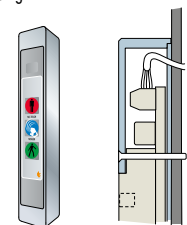

SLIM-HANDTRONIX stand alone unit type 4 for mounting placed on surface using housing. With extra-strong protective housing, made in anodized silver finish aluminium (35x25x215mm).

Fitted (instead of the manual push button) with an infrared sensor that "sees" a presence up to 10cm away.

Basically, the "contactless" door opening and/or doorbell command is automatically triggered by bringing the hand close to the unit, without actually touching it.

Self-adhesive cover in polycarbonate, provided separately and designed to be used as final cover to hide the 4 fixing screws of the housing on the door frame.

Useful when you wish to avoid recess-mounting or cuts on the door frame.

034994HM

290,00

Assembly type 5

for recessed wall-mounting with flange and wall-mounting receptacle

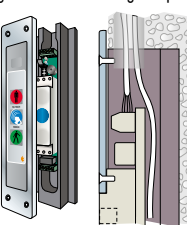

SLIM-HANDTRONIX stand alone unit type 5 for recessed assembly using flange and wall box. Fitted (instead of the manual push button) with an infrared sensor that "sees" a presence up to 10cm away. Supplied with front flange in anodized aluminium with "silver" finish - 250x50mm, thickness 4mm, to be fixed to the housing by placing on wall surface.

Self-adhesive cover in polycarbonate pre-assembled and fixed into the flange niche. Basically, the "contactless" door opening and/or doorbell command is automatically triggered by bringing the hand close to the unit, without actually touching it.

Also fitted with wall box with "wings" for rapid anchoring (65x30x230mm), in plastic taken from single block to be assembled "in a niche" in the wall to house the body of the standalone unit.

Wall niche and cable channel to be prepared beforehand.

034995HM

286,00

Special configurations available at extra charge: Cover with your logo and/or customized.

For sizes, measurements and details of chasing, application examples and connection diagrams, see page 40.

SLIM-HANDTRONIX STAND ALONE UNIT - sizes, application examples and connection diagram

Assembly type 1 total alignment, lock recessed into surface without flange

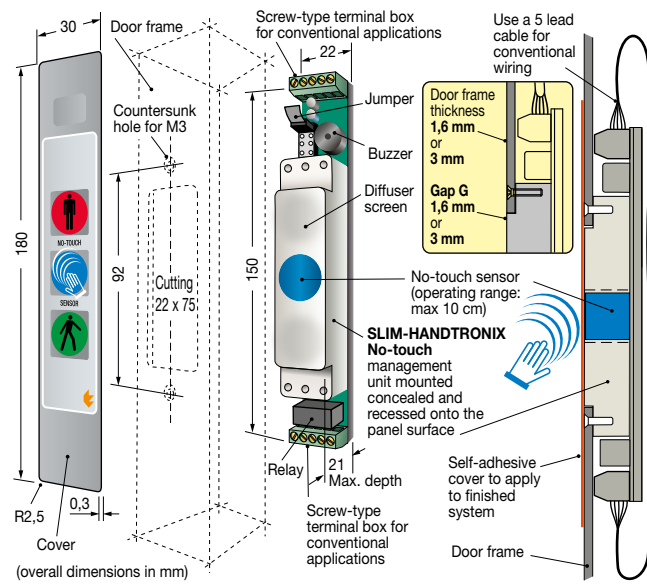

Assembly type 2 alignment at bottom with front flange "flush with surface" at bottom

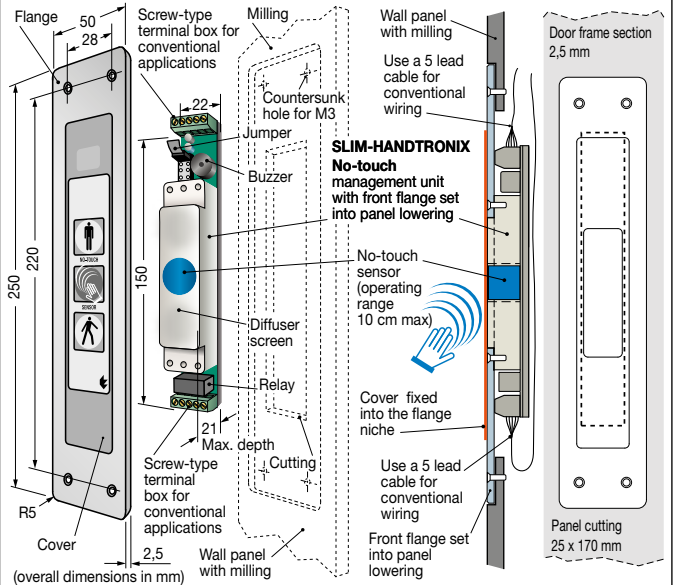

Assembly type 3 traditional fitting with front flange over the lock

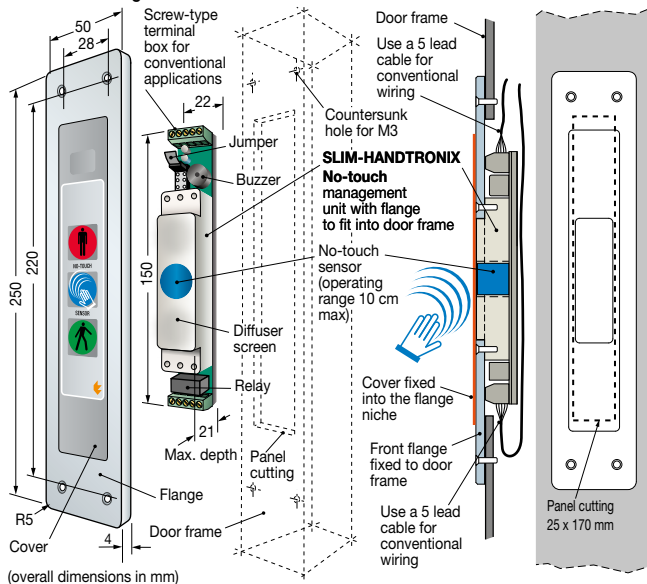

Assembly type 4 for mounting placed on surface using housing

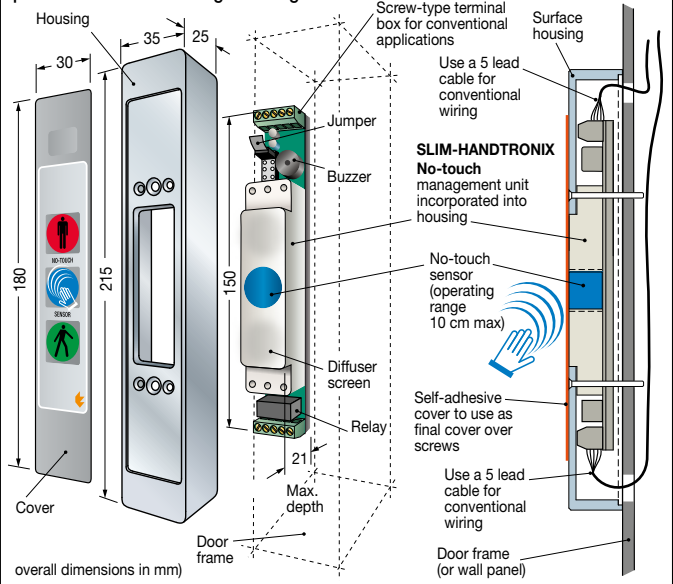

Assembly type 5 for recessed wall mounting with flange and wall box

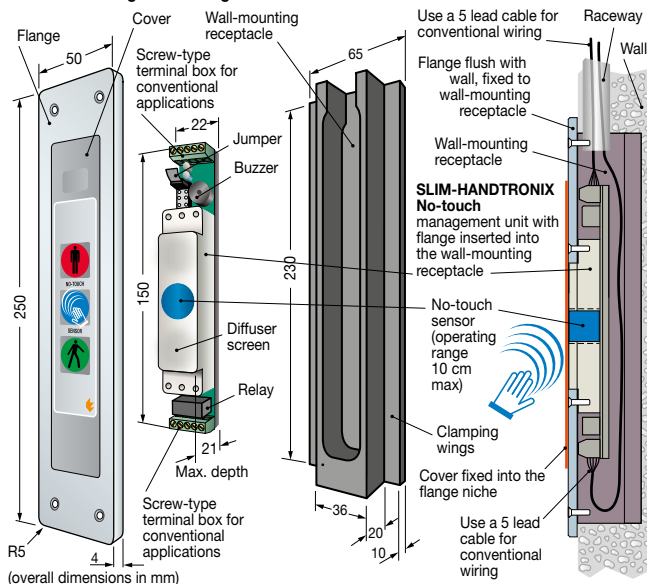

CONNECTION DIAGRAM valid for all 5 types

